

## VERTICAL SHIELD MODEL VS

### GENERAL DESCRIPTION

**FRAME** - 1-1/4" STAINLESS STEEL SQUARE TUBING. TO HAVE CLIPS FOR MOUNTING GLASS. ADDITIONAL UPRIGHT IS NEEDED FOR UNITS OVER 48". CONCEALED MOUNTING CLIPS.

**GLASS** - 1/4" PLATE GLASS WITH MOUNTING CLIPS.

### OPTIONS

- |                                                                       |                                                                |
|-----------------------------------------------------------------------|----------------------------------------------------------------|
| <input type="checkbox"/> STAINLESS STEEL - BRUSHED _____ MIRROR _____ | <input type="checkbox"/> TEMPERED GLASS                        |
| <input type="checkbox"/> POWDER COAT - COLOR _____                    | <input type="checkbox"/> LOW IRON CLEAR GLASS                  |
| <input type="checkbox"/> BRASS - BRUSHED _____ MIRROR _____           | <input type="checkbox"/> ALUMINUM - BRUSHED _____ MIRROR _____ |
| <input type="checkbox"/> SPECIAL WIDTH - _____                        | <input type="checkbox"/> SPECIAL HEIGHT _____                  |
| <input type="checkbox"/> MOUNTING - ABOVE COUNTER TOP                 | <input type="checkbox"/> MOUNTING - BELOW COUNTER TOP          |

### LIGHT/WARMER OPTIONS

- FLOURESCENT LIGHT - SLIMLINE     LED LIGHT - SLIMLINE     HEAT/LIGHT COMBO SLIMLINE

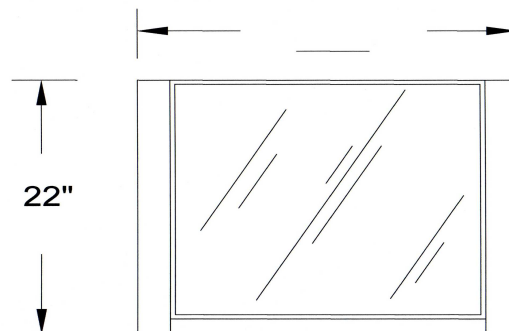

SECTION

MAXIMUM SPAN BETWEEN  
LEGS - 48 INCHES

\*APPROVED SHOP DRAWINGS REQUIRED  
MEETS NSF 2014 STANDARDS